

## S-Type Load Cell

MODEL STC-AL系列 **(aluminum)** 铝合金材质

### SPECIFICATIONS:

Standard Capacity	5kgAL, 10kgAL		
Recommended Excitation	10 V AC/DC	Compensated Temp. Range	-10°C to +40°C
Maximum Excitation	15 V AC/DC	Operating Temp. Range	-20°C to +60°C
Output at Rated Load	2 mV/V $\pm$ 10 %	Zero Balance	$\pm$ 1%
Hysteresis Error	0.02%	Input Resistance	410 $\pm$ 5 $\Omega$
Non Linearity	0.02%	Output Resistance	350 $\pm$ 3 $\Omega$
Non Repeatability	0.01%	Insulation Resistance (50VDC)	>5000 M $\Omega$
Creep (20 minutes)	0.03%	Deflection at Rated Load	<1 mm
Zero Return (20 minutes)	0.03%	Safe Overload	150%
Temp. Effect/10°C on Span	0.015%	Ultimate Overload	200%
Temp. Effect/10°C on Zero	0.026%		

### OUTLINE:

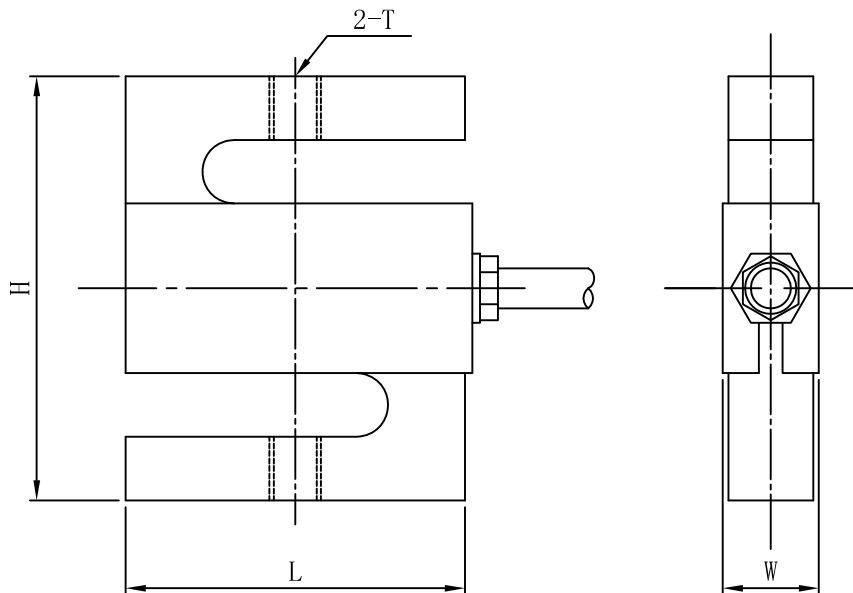

CABLE LENGTH: D3. 6/1. 5M

### DIMENSIONS:

CAPACITY	DIMENSIONS				
	L	W	H	T	
5kgAL, 10kgAL	(mm)	50.8	16.6	63.5	M6X1.0