

SMT

S-Beam Load Cells

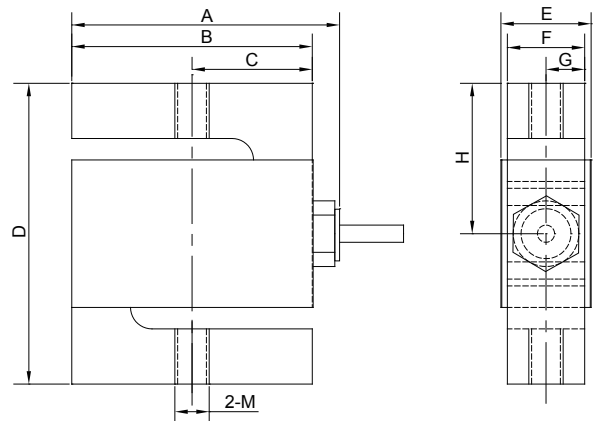

Specifications

Rated Output(mV/V): 2.0±0.02	Zero Balance: ±1%FS	Safe Overload: 150%	Cable Length: 4m
Nonlinearity: ±0.03%FS	Hysteresis: ±0.03%FS	Repeatability: ±0.03%FS	IP Class: IP66
Creep(30min.): ±0.03%FS	Input Resistance: 410±5 ohms	Output Resistance: 350±3 ohms	Cable Color Code: Red..... +EXC Black..... - EXC Green..... +SIG White..... - SIG
Insulation Resistance: ≥5000M ohms	Excitation Voltage: 5~10V DC(15V MAX)	Material: Aluminum	
Temperature: Compensated Range -10°C~+40°C	Temperature: Operating Range -20°C~+70°C		
Temp. Effect on Zero: ≤0.002%FS/°C	Temp. Effect on Output: ≤0.002%FS/°C		

Dimensions

RATED CAPACITY	A	B	C	D	E	F	G	H	M
kg/mm									
5~100	64	56	28	70	21	18	9	35	M8x1.25
N/mm									
50~1000	64	56	28	70	21	18	9	35	M8x1.25

Order Information

LOAD RATING	
SMT-50N(5kg)	SMT-100N(10kg)
SMT-200N(20kg)	SMT-300N(30kg)
SMT-500N(50kg)	SMT-1000N(100kg)

Interchangeable Products

MANUFACTURER	MODEL
VISHAY Celtron	STC
TRANSCELL	BAB