

# SSM

## S-Beam Load Cells

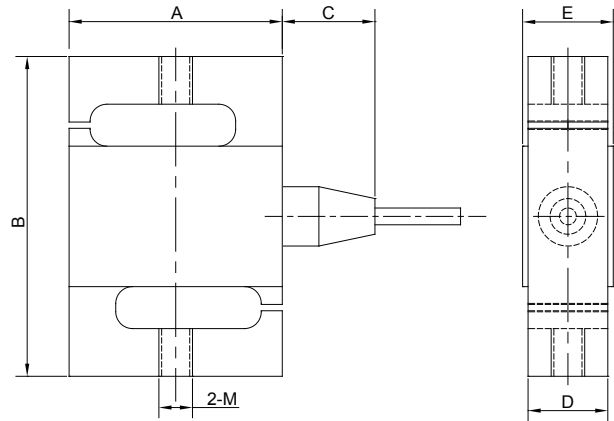

## Specifications

**Rated Output(mV/V):**

3.0±0.003

**Nonlinearity:**

±0.03%FS

**Creep(30min.):**

±0.03%FS

**Insulation Resistance:**

≥5000M ohms

**Temperature:**

Compensated Range

-10℃~+40℃

**Temp. Effect on Zero:**

≤0.002%FS/℃

**Zero Balance:**

±1%FS

**Hysteresis:**

±0.03%FS

**Input Resistance:**

385±20 ohms

**Excitation Voltage:**

5~10V DC(15V MAX)

**Temperature:**

Operating Range

-20℃~+70℃

**Temp. Effect on Output:**

≤0.002%FS/℃

**Safe Overload:**

150%

**Repeatability:**

±0.03%FS

**Output Resistance:**

350±5 ohms

**Material:**

Alloy steel

**Cable Length:**

6m

**IP Class:**

IP67

**Cable Color Code:**

Red..... + EXC

Black..... - EXC

Green..... + SIG

White..... - SIG

## Dimensions

RATED CAPACITY	A	B	C	D	E	M
<b>kg/mm</b>						
100	50.8	76.2	32	19	28	M10x1.5
200~750	50.8	76.2	32	19	28	M12x1.75
1000~1500	50.8	76.2	32	25.4	35	M12x1.75
2000~5000	76.2	108	32	25	31	M18x1.5
10000	127	177.8	17	50.4	57	M30x2
<b>kN/mm</b>						
1	50.8	76.2	32	19	28	M10x1.5
2~7.5	50.8	76.2	32	19	28	M12x1.75
10~15	50.8	76.2	32	25.4	35	M12x1.75
20~50	76.2	108	32	25	31	M18x1.5
100	127	177.8	17	50.4	57	M30x2

## Order Information

LOAD RATING	
SSM-1000N(100kg)	SSM-2000N(200kg)
SSM-2500N(250kg)	SSM-3000N(300kg)
SSM-5000N(500kg)	SSM-7500N(750kg)
SSM-10kN(1t)	SSM-15kN(1.5t)
SSM-20kN(2t)	SSM-25kN(2.5t)
SSM-30kN(3t)	SSM-50kN(5t)
SSM-100kN(10t)	

## Interchangeable Products

MANUFACTURER	MODEL
VISHAY Celtron	STC
INTERFACE	SSM
TRANSCCELL	BSS